

R'n'R San Diego Marathon & Half Both Courses

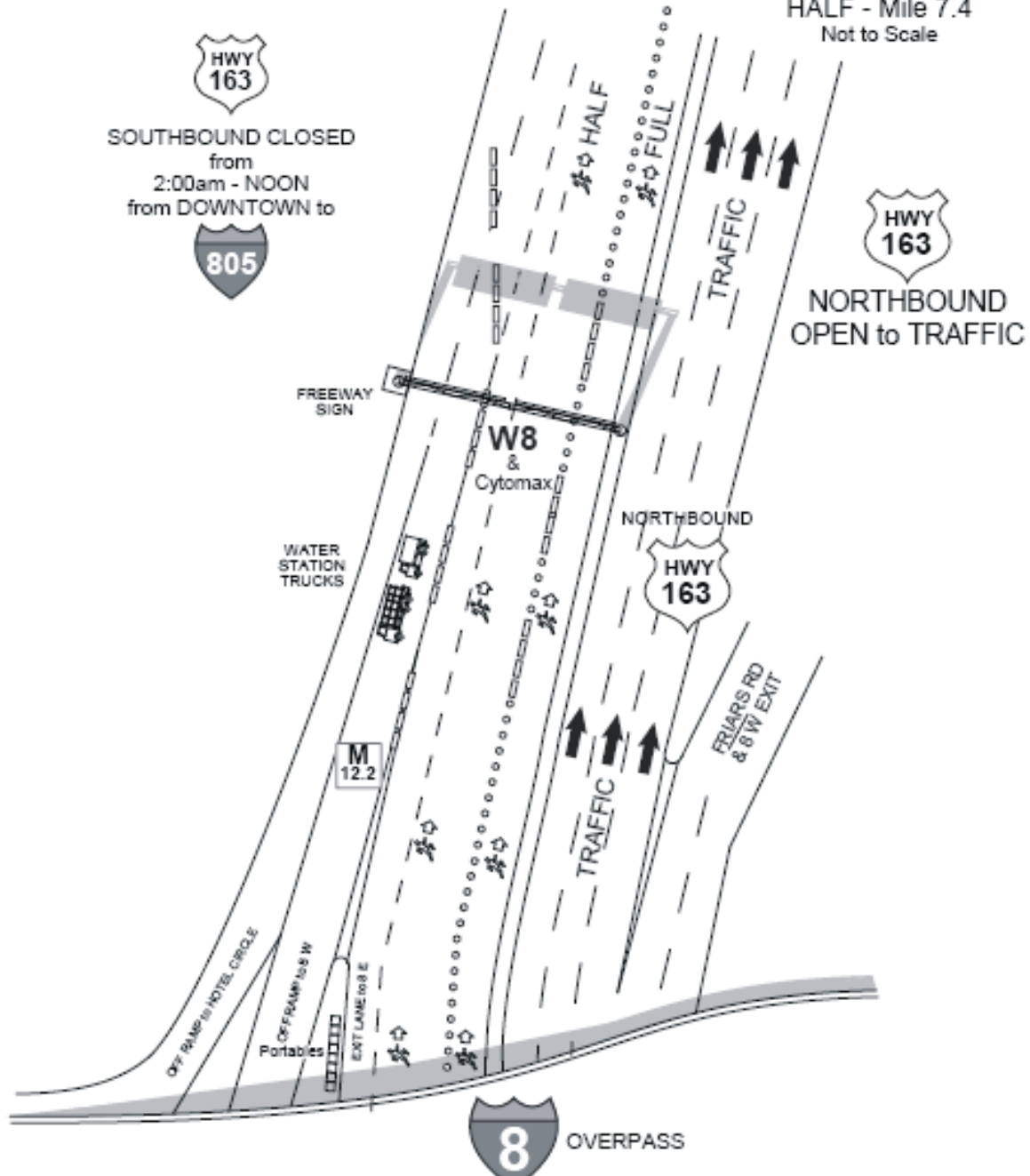

FULL - Mile 12.2
HALF - Mile 7.4
Not to Scale



Water Station 8 (All Times Are Approximated)

- 04:15am - Captains, UPS Truck Arrives
- 04:30am - Volunteers Arrive
- 05:30am - Streets Close
- 06:10am - Wheelchair Start
- 06:15am - Marathon Start
- 06:48am - First Athlete Arrives At W8
- 10:33am - Last Athlete Arrives At W8
- 10:50am - W8 Cleaned
- 12:00pm - Streets Re-opens

Team name:

Big 10 Clubs of San Diego

Team Captains:

Chris Mordy (858)722-0966

General:Linda Olson (619)550-7709

Water Station Coordinator:

Chris Giles (602)320-8883